

19 PAMPAS COURT, TUFFLEY, GLOUCESTER, GL4 0TB

PRICE £150,000

LEASEHOLD GLOUCESTER CITY COUNCIL B

Total Floor Area c.682 sq ft (63.43 sq mt)

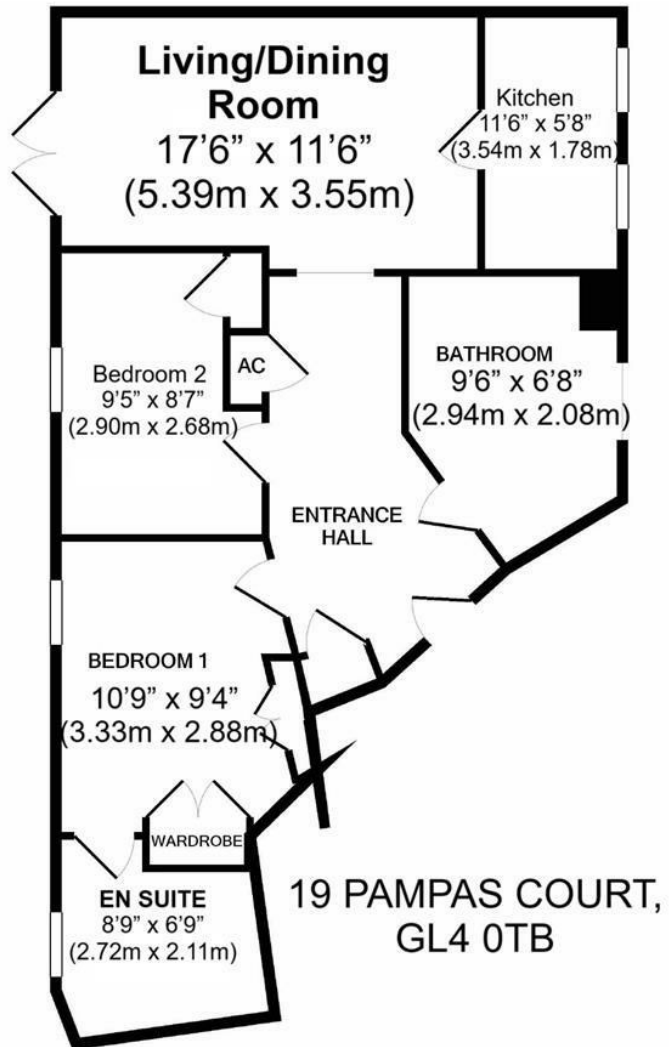

Floorplan for Guidance Only
Not to Scale





Price £150,000

All information subject to legal confirmation

Important Notice: SureLet have not tested any apparatus/installations/ services and cannot vouch for their condition. We therefore strongly recommend that their condition is verified by prospective purchaser(s) through surveyors or solicitors.

Money laundering regulations: To comply with money laundering regulations, prospective purchasers will be asked to produce identification documentation at the time of making an offer. We ask for your cooperation in order that there is no delay in agreeing the sale, should your offer be acceptable to the Seller(s).

SureLet may offer to assist in arranging insurance or other products/services and/or mortgages and may be entitled to receive commission in respect of any services provided. It is your decision whether you choose to deal with a company or service we recommend to you. In making that decision, you should know that we may receive referral fees worth between £200 and £1500 per annum



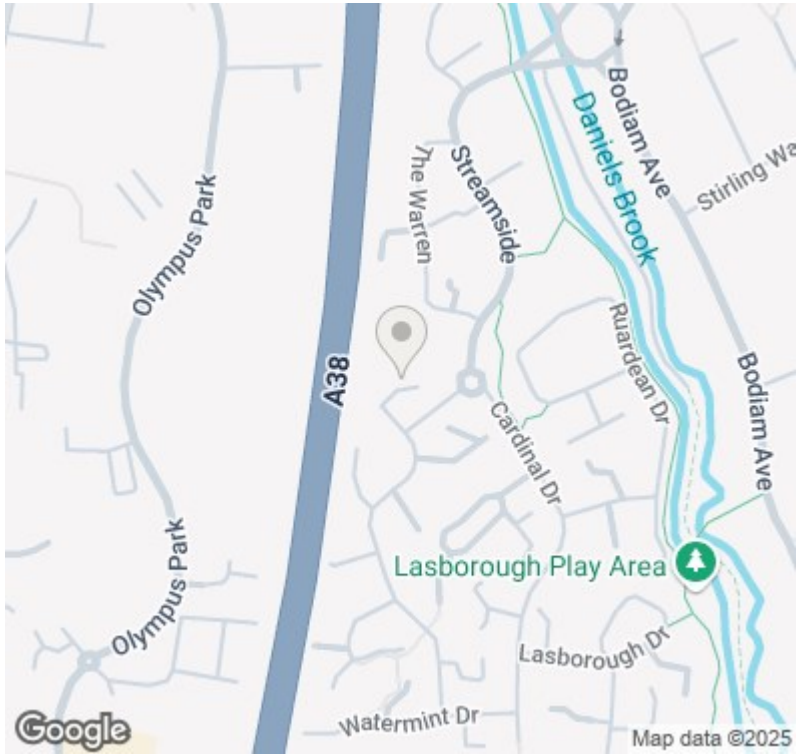

Energy Efficiency Rating

	Current	Potential
Very energy efficient - lower running costs		
(92 plus) A		
(81-91) B		
(69-80) C	77	79
(55-68) D		
(39-54) E		
(21-38) F		
(1-20) G		
Not energy efficient - higher running costs		
England & Wales	EU Directive 2002/91/EC	

Sure Property Group
23 Bath Street, Cheltenham
GL50 1YA
01242 241200
info@surecheltenham.co.uk

Gloucester City Council COUNCIL
TAX BAND B

Leasehold